

# AUTOMATIC TUBE WELD FITTINGS





# AUTOMATIC TUBE WELD FITTINGS

Components are ordered by product code as listed in this catalogue

## DESIGNATIONS PART NUMBER SYSTEM

<b>M</b>	<b>E</b>	<b>4</b>	<b>S</b>	<b>EP</b>
①	②	③	④	⑤

① Series	M	Micro Fitting L=6.35 mm
	S	Short Fitting L=10 mm
	L	Forged Fitting L=19.05 mm

② Product	E	Elbow
	T	Tee
	CT	Cross
	TB	Tribow
	R	Reducer

③ Size	2	1/8" OD
	4	1/4" OD
	6	3/8" OD
	8	1/2" OD
	12	3/4" OD
	16	1" OD

④ Material	S	Single Melt (316L)
	V	Double Melt (VIM+VAR)

⑤ Finishing	BA	Ry < 3.0μm
	EP	Ry < 0.7μm

AUTO  
TUBE  
WELD  
Fittings



# CONTENTS

## MICRO WELD FITTINGS

### MR

Micro Reducer

Pages 21



### ME

Micro Reducing 90° Elbow

Pages 21



### ME

Micro 90° Elbow

Pages 21



### MT

Micro Tee

Pages 22



### MT

Micro Reducing Tee

Pages 22



## FORGED WELD FITTINGS

### LE

90° Elbow

Pages 22



### LT

Tee

Pages 23



### LT

Reducing Tee

Pages 23



### LR,SR

Reducer

Pages 24



# AUTOMATIC TUBE WELD FITTINGS



## ■ 特徴 (Features)

- 材料：SUS316L VIN/VAR
- 材料のヒートコードを刻印する事により材料の管理が出来ます。
- 電解研磨仕様。
- 研磨面は100%目視検査実施。

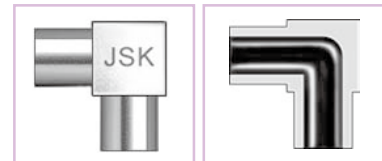

## ■ 素材

- ASTM A267 及び ASME SA479 に適合した 316 VIM/VAR 素材。推奨されるチューブ仕様は ASME SA213, ASTM A213, ASTM A269, MIL T8506, JIS G4303。

## ■ 仕様

- 使用圧力は使用するチューブによってに制限されます。周囲温度が ASME/ANSI B31.3 に適合する最大の許容負荷値を使用して計算した使用圧力は以下の表の通りです。
- 寸法は参考値であり、変化する可能性があります。
- 内部表面処理：標準処理マイクロフィッティングの内部表面の粗さは  $3.0\mu\text{m Ry}$ 。電解研磨マイクロフィッティングの内部表面の粗さは  $0.7\mu\text{m Ry}$ 。

Tube O.D.	Pressure Rating		Normal Wall Thickness mm
	psig	kgf/cm <sup>2</sup>	
1/4"OD	5100	358	1.0 (0.89)
3/8"OD	3300	232	1.0 (0.89)
1/2"OD	3500	246	1.24mm
3/4"OD	2400	160	1.24mm

Optional: 1/4"OD Wall Thickness 0.89mm

Designator	Surface Finish	
	(Ry)	(Ra)
EP	$\leq 0.7\mu\text{m}$	$\leq 5\mu\text{inch}$
BA	$\leq 3.0\mu\text{m}$	$\leq 10\mu\text{inch}$



# MICRO WELD FITTINGS

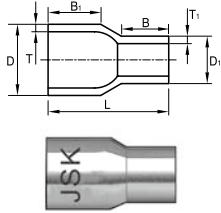

□: BA or EP

## Micro Reducer (MR)

Size (OD)	Size (OD <sub>1</sub> )	Ordering Number	D	D <sub>1</sub>	T	T <sub>1</sub>	B	B <sub>1</sub>	L
3/8"	1/4"	MR64S□	9.53	6.35	1.00	1.00	6.35	10.4	19.1
1/2"	1/4"	MR84S□	12.70	6.35	1.24	1.00	6.35	10.4	19.1
1/2"	3/8"	MR86S□	12.70	9.53	1.24	1.00	6.35	10.4	19.1
3/4"	1/4"	MR124S□	19.05	6.35	1.65	1.00	6.35	10.4	19.1
3/4"	3/8"	MR126S□	19.05	9.53	1.65	1.00	6.35	10.4	19.1
3/4"	1/2"	MR128S□	19.05	12.70	1.65	1.24	6.35	10.4	19.1

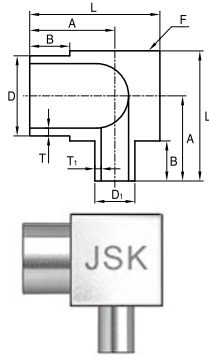

## Micro Reducing 90° Elbow (ME)

Size (OD)	Size (OD <sub>1</sub> )	Ordering Number	D	D <sub>1</sub>	T	T <sub>1</sub>	A	B	F Body Cube	L
3/8"	1/4"	ME64S□	9.53	6.35	1.00	1.00	11.91	6.35	11.11	17.46
1/2"	1/4"	ME84S□	12.70	6.35	1.24	1.00	13.50	6.35	14.29	20.64
1/2"	3/8"	ME86S□	12.70	9.53	1.24	1.00	13.50	6.35	14.29	20.64
3/4"	1/4"	ME124S□	19.05	6.35	1.65	1.00	16.68	6.35	20.65	27.00
3/4"	3/8"	ME126S□	19.05	9.53	1.65	1.00	16.68	6.35	20.65	27.00
3/4"	1/2"	ME128S□	19.05	12.70	1.65	1.24	16.68	6.35	20.65	27.00

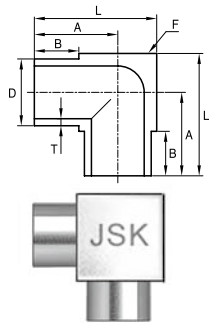

## Micro 90° Elbow (ME)

Size (OD)	Ordering Number	D	T	A	B	F Body Cube	L
1/4"	ME4S□	6.35	1.00	10.32	6.35	7.94	14.29
3/8"	ME6S□	9.53	1.00	11.91	6.35	11.11	17.46
1/2"	ME8S□	12.70	1.24	13.50	6.35	14.29	20.64
3/4"	ME12S□	19.05	1.65	16.68	6.35	20.65	27.00



# MICRO WELD FITTINGS

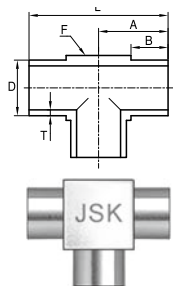

□: BA or EP

## Micro Tee (MT)

Size (OD)	Ordering Number	D	T	A	B	F Body Cube	L
1/4"	MT4S□	6.35	1.00	10.32	6.35	7.94	20.64
3/8"	MT6S□	9.53	1.00	11.91	6.35	11.11	23.81
1/2"	MT8S□	12.70	1.24	13.50	6.35	14.29	26.99
3/4"	MT12S□	19.05	1.65	16.68	6.35	20.65	33.35

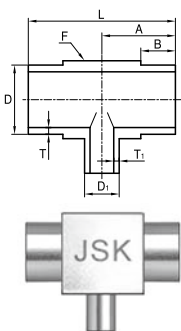

## Micro Reducing Tee (MT)

Size (OD)	Size (OD <sub>1</sub> )	Ordering Number	D	D <sub>1</sub>	T	T <sub>1</sub>	A	B	F Body Cube	L
3/8"	1/4"	MT64S□	9.53	6.35	1.00	1.00	11.91	6.35	11.11	23.81
1/2"	1/4"	MT84S□	12.70	6.35	1.24	1.00	13.50	6.35	14.29	26.99
1/2"	3/8"	MT86S□	12.70	9.53	1.24	1.00	13.50	6.35	14.29	26.99
3/4"	1/4"	MT124S□	19.05	6.35	1.65	1.00	16.68	6.35	20.65	27.00
3/4"	3/8"	MT126S□	19.05	9.53	1.65	1.00	16.68	6.35	20.65	27.00
3/4"	1/2"	MT128S□	19.05	12.70	1.65	1.24	16.68	6.35	20.65	27.00

AUTO  
TUBE  
WELD  
Fittings

# FORGED WELD FITTINGS

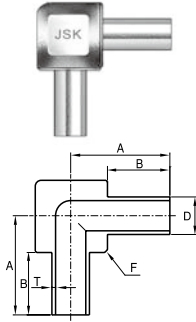

□: BA or EP

## 90° Elbow (LE,SE)

Size (OD)	Ordering Number	D	T	A	B	F Body Cube
1/4"	LE4S□	6.35	1.00	25.0	19.05	11.2
3/8"	LE6S□	9.53	1.00	25.0	19.05	11.2
1/2"	LE8S□	12.70	1.24	29.0	19.05	17.5
3/4"	LE12S□	19.05	1.65	35.8	23.30	25.0

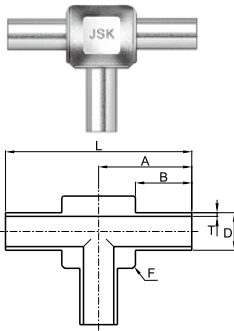

## Tee (LT,ST)

Size (OD)	Ordering Number	D	T	A	B	F Body Cube	L
1/4"	LT4S□	6.35	1.00	25.0	19.05	11.2	50.0
3/8"	LT6S□	9.53	1.00	25.0	19.05	11.2	50.0
1/2"	LT8S□	12.70	1.24	29.0	19.05	17.5	58.0
3/4"	LT12S□	19.05	1.65	35.8	23.30	25.0	71.6

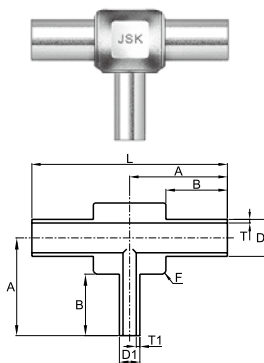

## Reducing Tee (LT,ST)

Size (OD)	Size (OD <sub>1</sub> )	Ordering Number	D	D <sub>1</sub>	T	T <sub>1</sub>	A	B	F Body Cube	L
3/8"	1/4"	LT64S□	9.53	6.35	1.00	1.00	25.0	19.05	11.2	50.0
1/2"	1/4"	LT84S□	12.70	6.35	1.24	1.00	29.0	19.05	17.5	58.0
1/2"	3/8"	LT86S□	12.70	9.53	1.24	1.00	29.0	19.05	17.5	58.0
3/4"	1/4"	LT124S□	19.05	6.35	1.65	1.00	35.8	23.30	25.0	71.6
3/4"	3/8"	LT126S□	19.05	9.53	1.65	1.00	35.8	23.30	25.0	71.6
3/4"	1/2"	LT128S□	19.05	12.70	1.65	1.24	35.8	23.30	25.0	71.6



# FORGED WELD FITTINGS

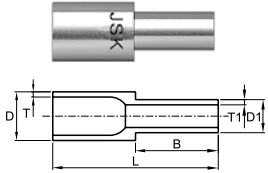

Reducer (LR,SR)								
Size (OD)	Size (OD <sub>1</sub> )	Ordering Number	D	D <sub>1</sub>	T	T <sub>1</sub>	B	L
3/8"	1/4"	LR64S□	9.53	6.35	1.00	1.00	19.05	38.10
1/2"	1/4"	LR84S□	12.70	6.35	1.24	1.00	19.05	38.10
1/2"	3/8"	LR86S□	12.70	9.53	1.24	1.00	19.05	38.10
3/4"	1/4"	LR124S□	19.05	6.35	1.65	1.00	19.05	42.90
3/4"	3/8"	LR126S□	19.05	9.53	1.65	1.00	19.05	42.90
3/4"	1/2"	LR128S□	19.05	12.70	1.65	1.24	19.05	42.90

AUTO  
TUBE  
WELD  
Fittings